

**A**

**F35 Filter**

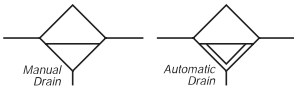

**Features**

- Compact Size Allows Greater Design Flexibility
- Nearly Double the Flow Capacity of Standard Miniature Filters; Reduces Costly Pressure Drop
- Connects to Other QUBE Units Using Just Screws and O-rings (Included)
- Integral Mounting Slots Eliminate Need for Mounting Brackets
- Excellent Water Removal Efficiency
- Unique Deflector Plate that Creates Swirling of the Air Stream Ensuring Maximum Water and Dirt Separation
- Large Filter Element Surface Guarantees Low Pressure Drop and Increased Element Life
- 20 Micron Filter Element Standard, 5 Micron Available
- Transparent Polyurethane Bowl Standard
- Metal Bowl with Wraparound Sight Gauge Optional
- Manual Drain as Standard, Optional Auto Pulse Drain
- Large Bowl Capacity
- High Flow: 1/8" - 32 SCFM<sup>§</sup>  
 1/4" - 38 SCFM<sup>§</sup>



**Polyurethane Bowls and Sight Gauges Offer Improved Chemical Compatibility.**

Port Size	NPT		BSPP	
	Manual Twist Drain	Piston Drain	Manual Twist Drain	Piston Drain
<b>Polyurethane Bowl</b>				
1/8"	<b>F35-01AH</b>	<b>F35-01AHS</b>	F35G01AH	F35G01AHS
1/4"	<b>F35-02AH</b>	<b>F35-02AHS</b>	F35G02AH	F35G02AHS
<b>Zinc Bowl / Sight Gauge</b>				
1/8"	<b>F35-01WH</b>	<b>F35-01WHS</b>	F35G01WH	F35G01WHS
1/4"	<b>F35-02WH</b>	<b>F35-02WHS</b>	F35G02WH	F35G02WHS

**Wraparound Sight Gauge Bowl**  
 All QUBE filters, lubricators, and integrals are available with the Watts Wraparound Polyurethane Sight Gauge Bowl. These unique bowls provide the 360° visibility of a plastic bowl while maintaining the high strength and safety features of metal bowls. Polyurethane bowls with guards, and metal bowls, are also available.

**Bold Items are Most Popular.**  
 For other models refer to ordering information below.

<sup>§</sup> SCFM = Standard Cubic Feet Per Minute at 100 PSIG Inlet, and 5 PSIG Pressure Drop with 20 Micron Element.

**Ordering Information**

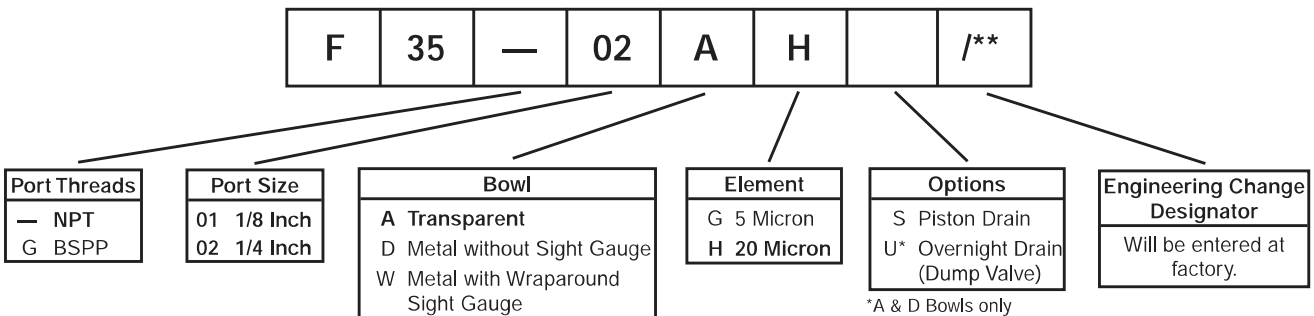

**BOLD ITEMS ARE MOST POPULAR.**



**Technical Information**

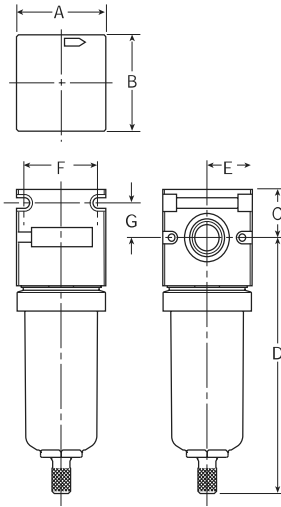

F35 Filter Dimensions						
A	B	C	D	E	F	G
<b>F35-AH, F35-DH</b>						
1.59 (40.5)	1.59 (40.5)	0.81 (20.6)	4.25 (107.9)	0.80 (20.2)	1.31 (33.3)	0.58 (14.7)
<b>F35-WH</b>						
1.59 (40.5)	1.59 (40.5)	0.81 (20.6)	4.27 (108.3)	0.80 (20.2)	1.31 (33.3)	0.58 (14.7)

Inches  
(mm)

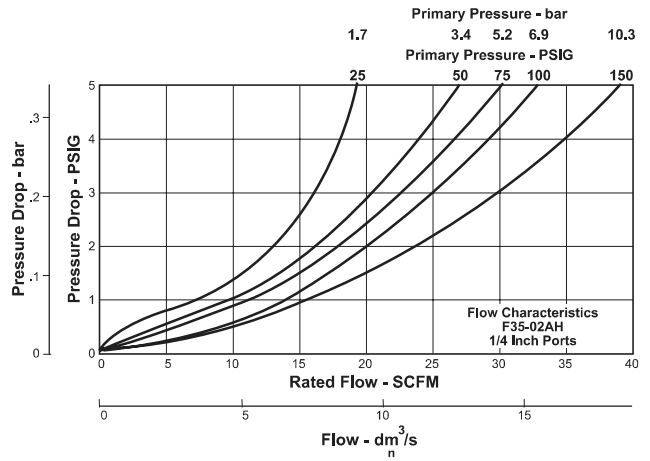
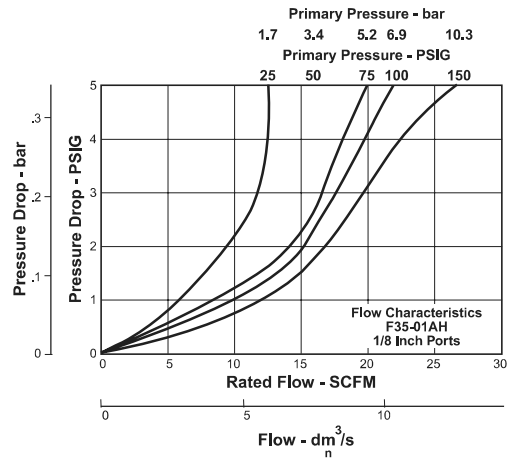

**F35 Filter Kits & Accessories**

**Bowl Kits –**

- Polyurethane (A)..... BKF35A
- Zinc (D)..... BKF35D
- Zinc (W) Wraparound Sight Gauge ..... BKF35W

**Drain Kits –**

- Manual Twist Drain ..... SA600Y7-1
- Piston (Max. Pressure: 175 PSIG)..... PKF35
- Semi-Automatic “Overnight” Drain ..... SA602A7  
 (Drains automatically under zero pressure)

**Filter Element Kits –**

- 5 Micron (All) ..... EK504VY
- 20 Micron (All) ..... EK504Y

**Face Mounting Bracket Kit (See Page A66) ..... SAR35Y57**

**Repair Kit –**

- Deflector, Retainer (All) ..... RFK30

**Specifications**

- Bowl Capacity** ..... 1.5 Ounce
- Port Threads** ..... 1/8, 1/4 Inch
- Pressure & Temperature Ratings –**
- Polyurethane Bowl..... 0 to 150 PSIG (0 to 10.2 bar)  
 40°F to 125°F (4.4°C to 52°C)

- Zinc Bowl..... 0 to 300 PSIG (0 to 20.4 bar)  
 40°F to 180°F (4.4°C to 82.2°C)
- With Piston Drain..... 175 PSIG Max. Press. (11.9 bar)  
 40°F to 150°F (4.4°C to 65.6°C)
- Zinc Bowl w/ Sight Gauge ..... 0 to 250 PSIG (0 to 17.2 bar)
- With Piston Drain..... 175 PSIG Max. Press. (11.9 bar)  
 40°F to 150°F (4.4°C to 65.6°C)

**Weight –**

- Polyurethane Bowl..... 0.7 lb. (0.3 kg) / Unit  
 18.9 lb. (8.6 kg) / 24-Unit Master Pack
- Zinc Bowl..... 0.9 lb. (0.4 kg) / Unit  
 23.9 lb. (10.8 kg) / 24-Unit Master Pack
- Zinc Bowl W/ Sight Gauge..... 0.96 lb. (0.4 kg) / Unit  
 25.1 lb. (11.4 kg) / 24-Unit Master Pack

**Materials of Construction**

- Body** ..... Zinc
- Bowls** ..... Polyurethane  
 Metal (Zinc)
- Drains** ..... Brass
- Filter Elements** ..... Polypropylene
- Seals** ..... Nitrile

